

WINSTEAD, SECHREST & MINICK

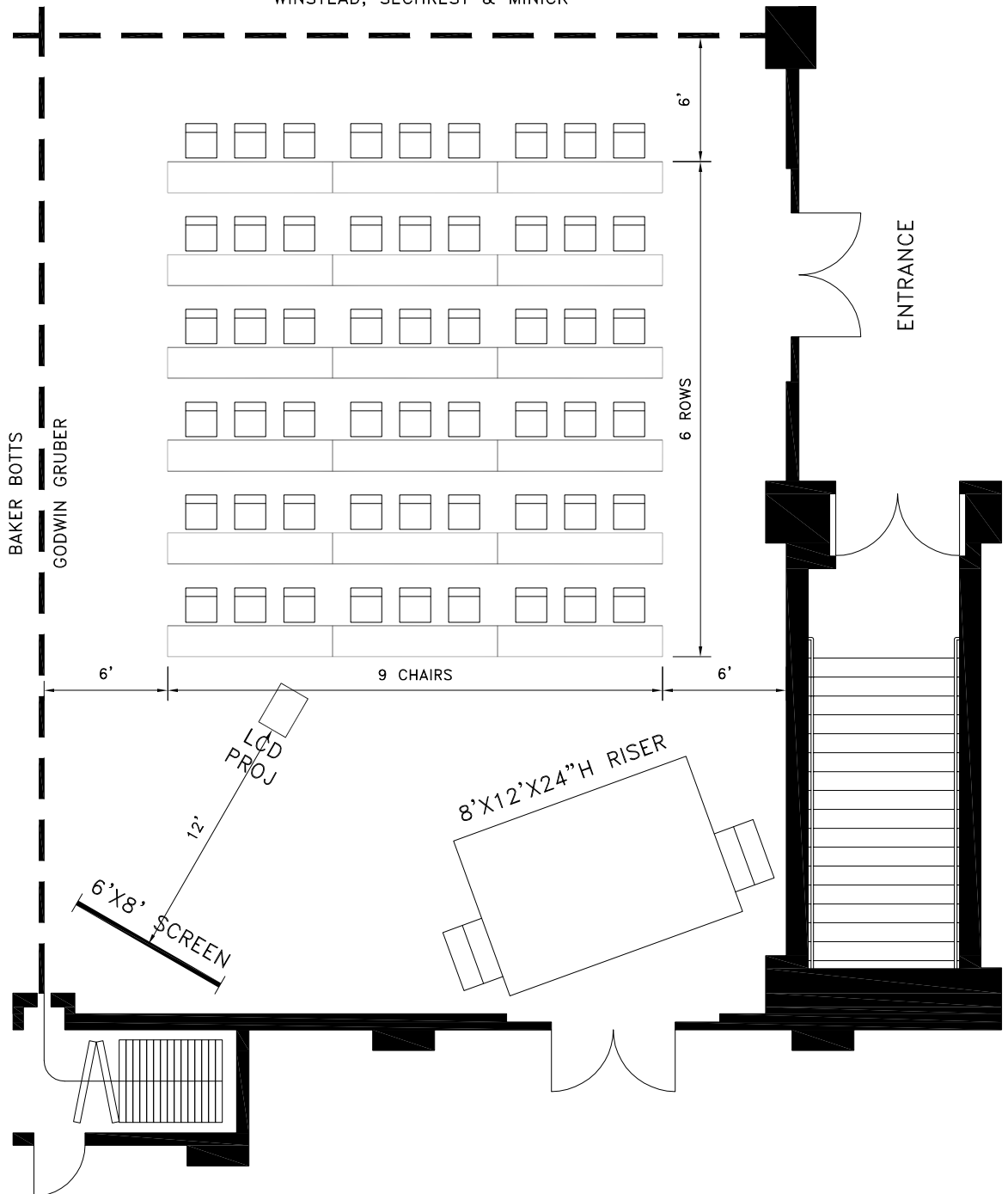

This drawing is intended to be used as a GUIDE of the APPROXIMATE room setup at this facility. Whereas actual on-site variations or adjustments may occur, AVHQ cannot be held responsible for submitting this as a final or exact plan.

DATE: 09/02/2003  
SCALE: 1/8" = 1'-0"  
DRAWN BY: GIVAS  
DRAWING NO.: BELOGGC

**THE PAVILION AT THE BELO MANSION**

DALLAS, TEXAS  
TOTAL SEATING: 54

ROOM: GODWIN GRUBER  
LAYOUT: CLASSROOM  
DIMENSION: 36'-0" X 47'-4"  
CEILING HEIGHT: 27'-0"

10540 STEMMONS FREEWAY  
DALLAS, TEXAS 75220-2425



TEL.: 888-369-9761  
FAX: 214-210-8149